

Assembly Instructions Accessories for Wet Zone

Rim Clamp for Floortrays

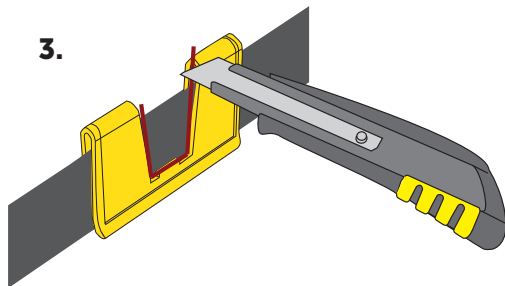
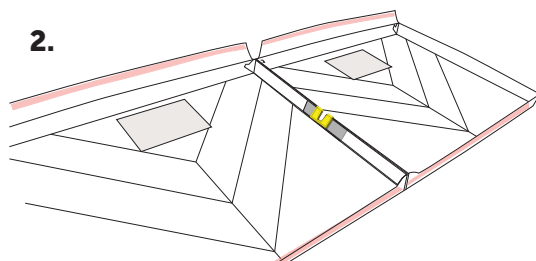
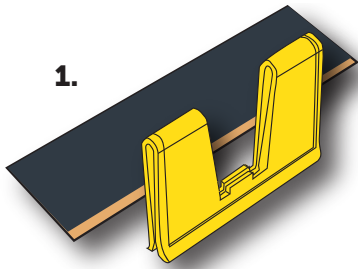

ASSEMBLY

1. Attach the foam tape on the short side to one of the floor protectors that you want to link together. The edge of the foam tape should be placed about 1–2 mm from the bottom of the edge. Peel off the protective film and push the floor protectors together.
2. Attach the Rim Clamp by pressing down over the edge of the protectors.
3. Cut out the U-shaped gap.

PACKAGE CONTENTS:

Double-sided tape for sealing, 15 cm. Rim clamp.

SCAN CODE FOR MORE INFO
ABOUT THE PRODUCT.



Product

Tollco Accessories for Wet Zone Rim Clamp for Floortrays

RSK

8080770

Item no.

3801001-08-001

TOLLCO AB

Rubanksgatan 4, 741 71 Knivsta, Sweden
Tel +46 18 34 90 10. info@tollco.se tollco.se



Accepterad
monteringsanvisning
2021-1

TOLLCO

Your protection against water damage

20211012