

# Tollco Accessories for Wet Zone

## Flood protection kitchen with check valve

Drain  
with check  
valve.

- **Drains water leakage to wastewater pipe.**
- **Quick, easy and maintenance-free installation.**

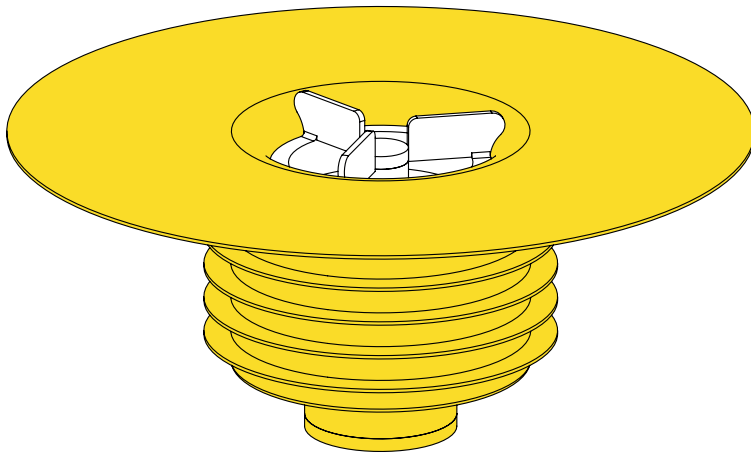

Flood protection is the easiest way to divert leaking water to a wastewater pipe without installing a floor drain.

The installation is simple and quick and requires minimal maintenance. The flood protection is mounted in drain pipes with a diameter of 75 mm. The check valve prevents unpleasant odours from seeping out of the drain.

**Installation:** The prerequisite for installing the flood protection in the kitchen is that a drain manifold comes up out of the floor. Therefore, it is important to plan the drain manifold in the kitchen floor (under the sink cabinet) when building a new house. Connection to the manifold is done from the sink and to the flood protection.

SCAN CODE FOR MORE INFO  
ABOUT THE PRODUCT.



Product	RSK	Item no.
Tollco Accessories for Wet Zone Flood protection kitchen with check valve	712 95 09	3800001-09-001



Accepterad  
monteringsanvisning  
2021:1



Made in Sweden.  
Recommended by insurance companies.

**TOLLCO AB** Rubanksgatan 4, 741 71 Knivsta, Sweden  
Tel +46 18 34 90 10. [info@tollco.se](mailto:info@tollco.se) [tollco.se](http://tollco.se)

**TOLLCO**  
Your protection against water damage